

APPLICABLE STANDARD	
Design&Manufacture	<b>AWWA C508</b>
End Connection	ASME B16.1 CL125/ ASME B16.42 CL150
Face-to-Face and End-to-End Dimensions	<b>AWWA C508</b>
Working Temperature	32°F -176°F
Medium	Water

TESTING DETAILS	
DESCRIPTION	TEST PRESSURE
SHELL TEST	600PSI
SEAT TEST	450PSI

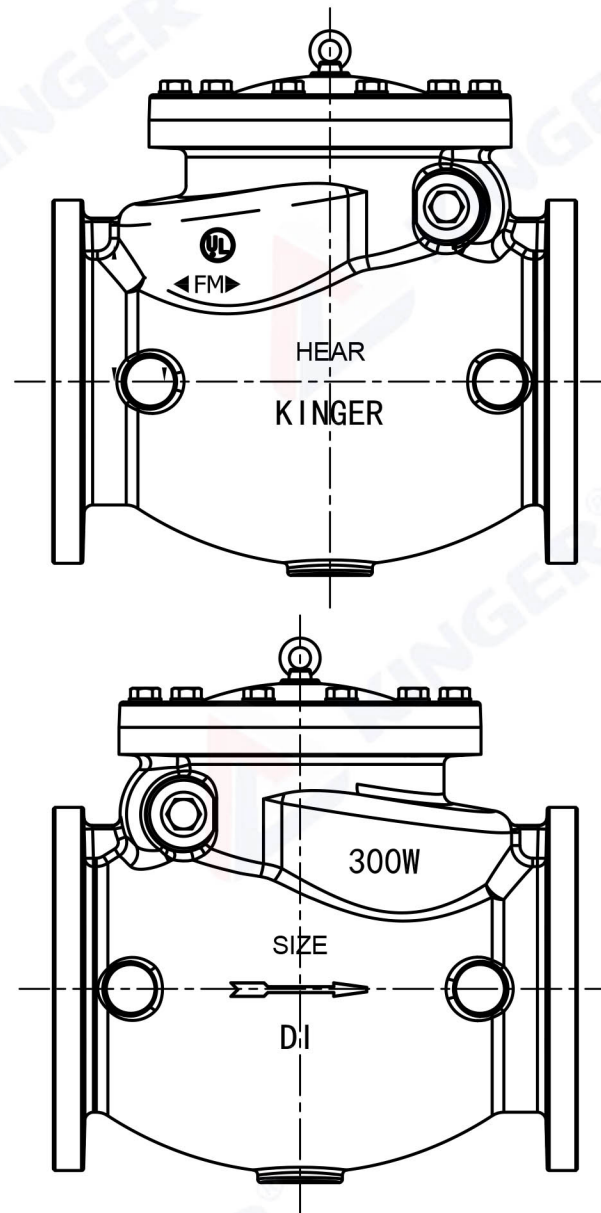
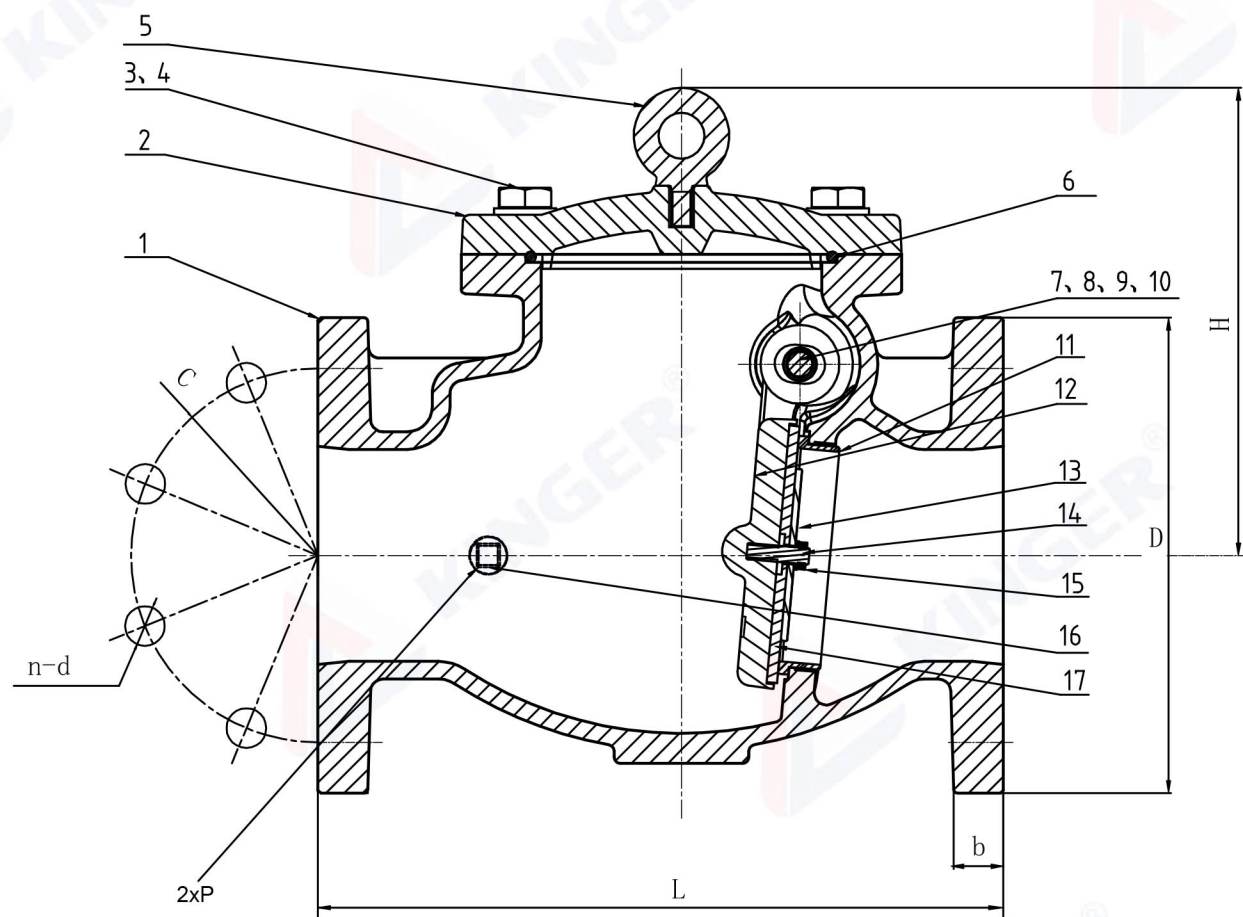
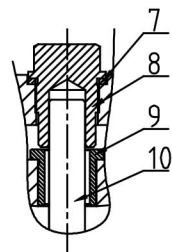

PART NO.	Description	Material Specification
1	Body	Ductile Iron ASTM A536
2	Bonnet	Ductile Iron ASTM A536
3	Bolt	Stainless Steel 304 ASTM A276
4	Flat Washer	Stainless Steel 304 ASTM A276
5	Eye Bolt	Carbon Steel Zinc Plated
6	O-Ring	EPDM ASTM D2000
7	Washer	PTFE
8	Plug	Stainless Steel 304 ASTM A276
9	Hinge bushing	CW617N
10	Hinge Pin	Stainless Steel 420
11	Seat Ring	HPb57-3
12	Disc	Ductile Iron ASTM A536
13	Baffle Plate	2-4" Stainless Steel 304
		6-12" Ductile Iron ASTM A536
14	Bolt	Stainless Steel 304 ASTM A276
15	Nut	Stainless Steel 304 ASTM A276
16	Plug	HPb57-3
17	Seal	EPDM ASTM D2000

Item No.	Dimensions(Inch)								
	Size	D	C	b	n	d	L	H	P
JKDCV-F300B02	2"	6.00	4.75	0.62	4	0.750	8.00	5.28	3/8 NPT
JKDCV-F300B025	2.5"	7.00	5.50	0.69	4	0.750	10.00	5.79	3/8 NPT
JKDCV-F300B03	3"	7.50	6.00	0.75	4	0.750	11.00	5.91	1/2 NPT
JKDCV-F300B04	4"	9.00	7.50	0.94	8	0.750	13.00	8.86	1/2 NPT
JKDCV-F300B06	6"	11.00	9.50	1.00	8	0.875	16.00	11.81	3/4 NPT
JKDCV-F300B08	8"	13.50	11.75	1.12	8	0.875	19.50	14.06	3/4 NPT
JKDCV-F300B10	10"	16.00	14.25	1.19	12	1.000	24.50	16.54	3/4 NPT
JKDCV-F300B12	12"	19.00	17.00	1.25	12	1.000	26.00	18.11	3/4 NPT

DESCRIPTION		Proj.	JKDCV-F300B-001
<b>AWWA C508 Flanged Resilient Swing Check Valve</b>		DWG#	REV.
		JKDCV-002	0
		WN	APPR.
CUSTOMER		CINDY	KUHN HU
PAGE NO		1 of 1	For special material requests beyond the standard specifications, please clearly note them on your inquiry or order form.

