

Item No.	NPS	Dimensions(Inch)											
		A	B	C	D	E	F	G	H	J	K	L	S
KPL175-GH03	3"	8.00	0.75	3.54	6.08	1.58	7.87	6.00	0.75	4	5/8-11UNC	N/A	8.0
KPL175-GH04	4"	9.00	0.94	4.53	7.00	1.58	9.00	7.50	0.75	6	5/8-11UNC	2	8.0
KPL175-GH06	6"	10.50	1.00	5.79	8.74	1.58	11.22	9.50	0.88	6	3/4-10UNC	2	12.0
KPL175-GH08	8"	11.50	1.13	7.33	10.51	1.90	13.50	11.75	0.88	6	3/4-10UNC	2	18.0
KPL175-GH10	10"	13.00	1.19	9.06	12.52	1.90	16.00	14.25	1.00	8	7/8-9UNC	4	20.0
KPL175-GH12	12"	14.00	1.25	10.24	13.96	1.90	19.00	17.00	1.00	8	7/8-9UNC	4	24.0

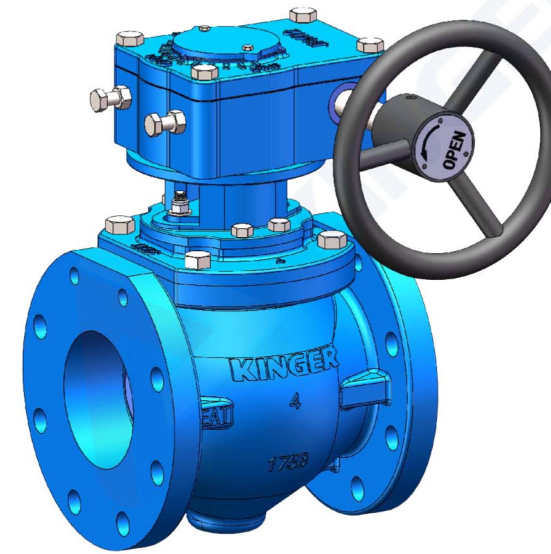

Specification			
Cold Working Pressure (CWP)	175	PSI	
Test Pressure	Shell Test(Hyd.)		265
	Seal Test(Hyd.)		175
	Reverse Pressure Test(Hyd.)	175	
Working Temperature	32°F -176°F		
Medium	Water		

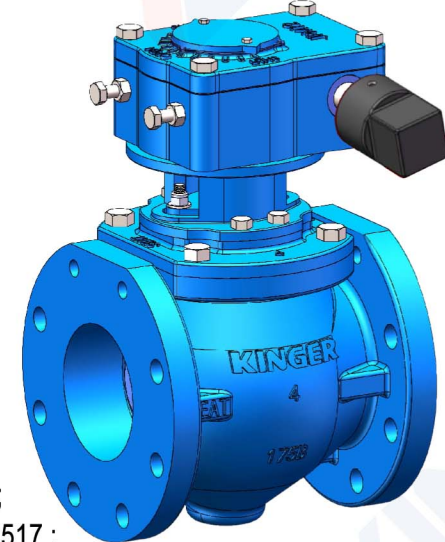

NOTES:

1. ALL DIMENSIONS ARE IN INCHES ;
2. DESIGN STANDARD PER AWWA C517 ;
3. FLANGE STANDARD PER ASME B16.1 CLASS125 ;

1	ADAPTER	ASTM A536 65-45-12	
2	GLAND FASTENER	SS316	
3	GLAND	ASTM A536 65-45-12	
4	BOLTS	SS316	
5	BONNET	ASTM A536 65-45-12	
6	O-RING	NBR	
7	V-PACKING	NBR	
8	SLEEVE BEARING	SS316	
9	GRIT SEAL	NBR	
10	THRUST WASHER	PTFE	
11	PLUG	ASTM A536 65-45-12+NBR	
12	BODY	ASTM A536 65-45-12+95%Ni	
13	Worm Gear	Assembly	
Part No.	DESCRIPTION	MATERIAL	
	DESCRIPTION	Proj. KPL175-GH	
AWWA C517 Flanged Eccentric Plug Valve	DWG#	REV.	
	KPL-001	1	
	DWN	APPR.	DATE
	CINDY	KUHN	9/23/2021

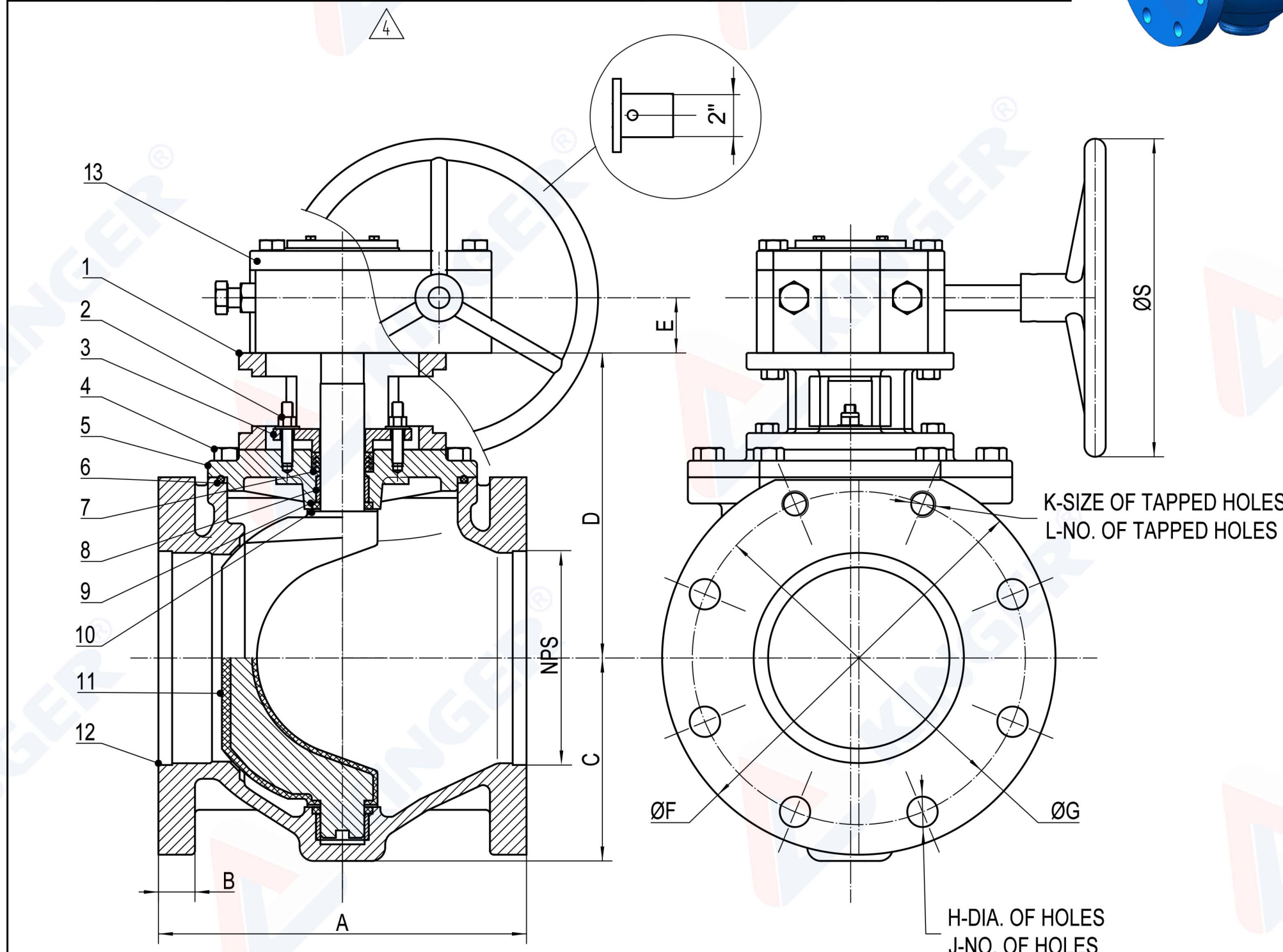

CUSTOMER	 KINGER INDUSTRY INC.		
PAGE NO.	1 of 1	KINGER RESERVES THE RIGHT TO CHANGE DESIGN & MATERIAL WITHOUT PRIOR NOTICE PLEASE CONNECT KINGER FOR UPDATED DATA BEFORE PLACING THE ORDER.	