

2" - 54" DUCTILE IRON FLANGED FITTINGS

MATERIALS:	Ductile Iron: ASTM A536
PRESSURE RATING:	250 PSI Water Working Pressure for Ductile Iron sizes 2" - 54
TESTING:	In accordance with AWWA/ANSI C110/A21.10 where applicable. Other items are in accordance with Manufacturer s standards.
LAYING LENGTH:	In accordance with AWWA/ANSI C110/A21.10 where applicable. Other items are in accordance with Manufacturer s standards.
CEMENT LINING:	In accordance with AWWA/ANSI C104/A21.4.
COATING:	Tar coated (bituminous) inside in accordance with AWWA/ANSI C104/A21.4. Red primer outside. For special conditions, other types of coatings and linings are available. Please specify when ordering.
STANDARDS:	AWWA/ANSI C110/A21.10 where applicable. Other items are in accordance with Manufacturer's standards.

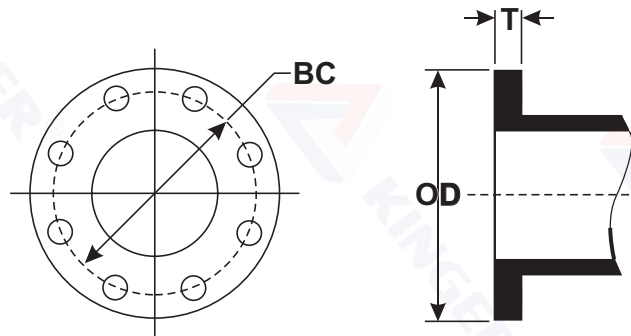

FLANGE DETAILS

Size	OD	BC	T	Hole Dia.	Bolt Size	No. Bolts
2	6.00	4.75	.62	.75	5/8 x 2 1/2	4
3	7.50	6.00	.75	.75	5/8 x 2 1/2	4
4	9.00	7.50	.94	.75	5/8 x 3	8
5	10.00	8.50	.94	.88	3/4 x 3	8
6	11.00	9.50	1.00	.88	3/4 x 3 1/2	8
8	13.50	11.75	1.12	.88	3/4 x 3 1/2	8
10	16.00	14.25	1.19	1.00	7/8 x 4	12
12	19.00	17.00	1.25	1.00	7/8 x 4	12
14	21.00	18.75	1.38	1.12	1 x 4 1/2	12
16	23.50	21.25	1.44	1.12	1 x 4 1/2	16
18	25.00	22.75	1.56	1.25	1 1/8 x 5	16
20	27.50	25.00	1.69	1.25	1 1/8 x 5	20
24	32.00	29.50	1.88	1.37	1 1/4 x 5 1/2	20
30	38.75	36.00	2.12	1.37	1 1/4 x 6 1/2	28
36	46.00	42.75	2.38	1.62	1 1/2 x 7	32
42	53.00	49.50	2.62	1.62	1 1/2 x 7 1/2	36
48	59.50	56.00	2.75	1.62	1 1/2 x 8	44
54	66.25	62.75	3.00	2.00	1 3/4 x 8 1/2	44

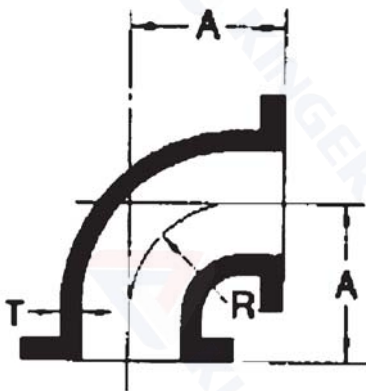

BENDS, 1/4 (90 DEG)

Size	DUCTILE IRON Item No.	A	R	T	Wt.
2	DIFB290	4.5	3.0	.31	16
3	DIFB390	5.5	4.0	.48	25
4	DIFB490	6.5	4.5	.52	40
5	DIFB590	7.5	5.5	.52	52
6	DIFB690	8.0	6.0	.55	65
8	DIFB890	9.0	7.0	.60	105
10	DIFB1090	11.0	9.0	.80	165
12	DIFB1290	12.0	10.0	.87	235
14	DIFB1490	14.0	11.5	.66	290
16	DIFB1690	15.0	12.5	.70	370
18	DIFB1890	16.5	14.0	.75	450
20	DIFB2090	18.0	15.5	.80	580
24	DIFB2490	22.0	18.5	.89	900
30	DIFB3090	25.0	21.5	1.03	1430
36	DIFB3690	28.0	24.5	1.15	2135
42	DIFB4290	31.0	27.5	1.28	3055
48	DIFB4890	34.0	30.5	1.42	4095
54	DIFB5490	37.0	33.5	1.62	6695



BENDS, 1/8 (45 DEG)

Size	DUCTILE IRON Item No.	A	R	T	Wt.
2	DIFB245	2.5	2.41	.31	12
3	DIFB345	3.0	3.62	.48	20
4	DIFB445	4.0	4.81	.52	40
5	DIFB545	4.5	6.04	.52	45
6	DIFB645	5.0	7.25	.55	55
8	DIFB845	5.5	8.44	.60	90
10	DIFB1045	6.5	10.88	.80	130
12	DIFB1245	7.5	13.25	.87	195
14	DIFB1445	7.5	12.06	.66	220
16	DIFB1645	8.0	13.25	.70	280
18	DIFB1845	8.5	14.50	.75	325
20	DIFB2045	9.5	16.88	.80	430
24	DIFB2445	11.0	18.12	.89	630
30	DIFB3045	15.0	27.75	1.03	1120
36	DIFB3645	18.0	35.00	1.15	1755
42	DIFB4245	21.0	42.25	1.28	2600
48	DIFB4845	24.0	49.50	1.42	3580
54	DIFB5445	27.0	55.68	1.62	5755

BENDS, 1/16 (22 1/2 DEG)



Size	DUCTILE IRON Item No.	A	R	T	Wt.
2	DIFB222	2.5	6.04	.31	12
3	DIFB322	3.0	7.66	.48	20
4	DIFB422	4.0	10.06	.52	40
5	DIFB522	4.5	10.86	.52	45
6	DIFB622	5.0	15.06	.55	55
8	DIFB822	5.5	17.62	.60	90
10	DIFB1022	6.6	22.62	.80	135
12	DIFB1222	7.5	27.62	.87	205
14	DIFB1422	7.5	25.12	.66	225
16	DIFB1622	8.0	27.62	.70	285
18	DIFB1822	8.5	30.19	.75	335
20	DIFB2022	9.5	35.19	.80	435
24	DIFB2422	11.0	37.69	.89	640
30	DIFB3022	15.0	57.81	1.03	1135
36	DIFB3622	18.0	72.88	1.15	1790
42	DIFB4222	21.0	88.00	1.28	2665
48	DIFB4822	24.0	103.06	1.42	3665

BENDS, 1/32 (11 1/4 DEG)



Size	DUCTILE IRON Item No.	A	R	T	Wt.
2	DIFB211	2.5	12.69	.31	12
3	DIFB311	3.0	15.25	.48	20
4	DIFB411	4.0	20.31	.52	40
5	DIFB511	4.5	22.85	.52	45
6	DIFB611	5.0	30.50	.55	55
8	DIFB811	5.5	35.50	.60	90
10	DIFB1011	6.5	45.69	.80	135
12	DIFB1211	7.5	55.81	.87	205
14	DIFB1411	7.5	50.75	.66	225
16	DIFB1611	8.0	55.81	.70	285
18	DIFB1811	8.5	60.90	.75	335
20	DIFB2011	9.5	71.06	.80	435
24	DIFB2411	11.0	76.12	.89	645
30	DIFB3011	15.0	116.75	1.03	1150
36	DIFB3611	18.0	147.25	1.15	1805
42	DIFB4211	21.0	177.69	1.28	2680
48	DIFB4811	24.0	208.12	1.42	3695

Available in gray cast iron and ductile iron.

Manufactured in accordance with AWWA/ANSI C110/A21.10.

54" fittings are manufactured in accordance with manufacturer's standards in general guidance of AWWA/ANSI C110/A21.10

Flanges are drilled and faced in accordance with ANSI B16.1 CLASS 125

Dimensions in inches

Weights in pounds

REDUCING BENDS, 90 DEG

Size	DUCTILE IRON Item No.	A	R	T	T ₁	Wt.
3 x 2	DFRB32	5.6	4.0	.48	.31	22
4 x 3	DFRB43	6.5	4.5	.52	.48	29
6 x 3	DFRB63	8.0	6.0	.55	.48	56
6 x 4	DFRB64	8.0	6.0	.55	.52	55
6 x 5	DFRB65	8.0	6.0	.55	.52	65
8 x 4	DFRB84	9.0	7.0	.60	.52	75
8 x 5	DFRB85	9.0	7.0	.60	.52	80
8 x 6	DFRB86	9.0	7.0	.60	.55	85
10 x 4	DFRB104	11.0	9.0	.68	.52	130
10 x 6	DFRB106	11.0	9.0	.68	.55	135
10 x 8	DFRB108	11.0	9.0	.68	.60	150
12 x 4	DFRB124	12.0	10.0	.75	.52	140
12 x 6	DFRB126	12.0	10.0	.75	.55	160
12 x 8	DFRB128	12.0	10.0	.75	.60	180
12 x 10	DFRB1210	12.0	10.0	.75	.68	200
14 x 6	DFRB146	14.0	11.5	.66	.55	144
14 x 8	DFRB148	14.0	11.5	.66	.60	215
14 x 10	DFRB1410	14.0	11.5	.66	.68	240
14 x 12	DFRB1412	14.0	11.5	.66	.75	270
16 x 6	DFRB166	15.0	12.5	.70	.55	220
16 x 8	DFRB168	15.0	12.5	.70	.60	240
16 x 10	DFRB1610	15.0	12.5	.70	.68	280
16 x 12	DFRB1612	15.0	12.5	.70	.75	310
16 x 14	DFRB1614	15.0	12.5	.70	.66	335
18 x 6	DFRB186	16.5	14.0	.75	.55	260
18 x 8	DFRB188	16.5	14.0	.75	.60	330
18 x 10	DFRB1810	16.5	14.0	.75	.68	330
18 x 12	DFRB1812	16.5	14.0	.75	.75	350
18 x 14	DFRB1814	16.5	14.0	.75	.66	385
18 x 16	DFRB1816	16.5	14.0	.75	.70	420
20 x 6	DFRB206	18.0	15.5	.80	.55	320
20 x 8	DFRB208	18.0	15.5	.80	.60	345
20 x 10	DFRB2010	18.0	15.5	.80	.68	445
20 x 12	DFRB2012	18.0	15.5	.80	.75	415
20 x 14	DFRB2014	18.0	15.5	.80	.66	455
20 x 16	DFRB2016	18.0	15.5	.80	.70	495
20 x 18	DFRB2018	18.0	15.5	.80	.75	525
24 x 6	DFRB246	22.0	18.5	.89	.55	480
24 x 8	DFRB248	22.0	18.5	.89	.60	505
24 x 10	DFRB2410	22.0	18.5	.89	.68	545
24 x 12	DFRB2412	22.0	18.5	.89	.75	575
24x 14	DFRB2414	22.0	18.5	.89	.66	635
24 x 16	DFRB2416	22.0	18.5	.89	.70	685
24 x 18	DFRB2418	22.0	18.5	.89	.75	675
24 x 20	DFRB2420	22.0	18.5	.89	.80	740

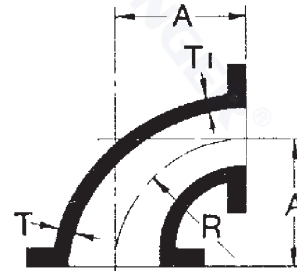

Size	DUCTILE IRON Item No.	A	R	T	T ₁	Wt.
30 x 12	DFRB3012	25.0	21.5	1.03	.75	840
30 x 14	DFRB3014	25.0	21.5	1.03	.66	1090
30 x 16	DFRB3016	25.0	21.5	1.03	.70	900
30 x 18	DFRB3018	25.0	21.5	1.03	.75	980
30 x 20	DFRB3020	25.0	21.5	1.03	.80	1070
30 x 24	DFRB3024	25.0	21.5	1.03	.89	1205
36 x 12	DFRB3612	28.0	24.5	1.15	.75	1195
36 x 14	DFRB3614	28.0	24.5	1.15	.66	1215
36 x 16	DFRB3616	28.0	24.5	1.15	.70	1255
36 x 18	DFRB3618	28.0	24.5	1.15	.75	1295
36 x 20	DFRB3620	28.0	24.5	1.15	.80	1360
36 x 24	DFRB3624	28.0	24.5	1.15	.89	1520
36 x 30	DFRB3630	28.0	24.5	1.15	1.03	1785
42 x 12	DFRB4212	31.0	27.5	1.28	.75	1655
42 x 14	DFRB4214	31.0	27.5	1.28	.66	1675
42 x 16	DFRB4216	31.0	27.5	1.28	.70	1715
42 x 18	DFRB4218	31.0	27.5	1.28	.75	1755
42 x 20	DFRB4220	31.0	27.5	1.28	.80	1895
42 x 24	DFRB4224	31.0	27.5	1.28	.89	1980
42 x 30	DFRB4230	31.0	27.5	1.28	1.03	2345
42 x 36	DFRB4236	31.0	27.5	1.28	1.15	3390
48 x 12	DFRB4812	34.0	30.5	1.42	.75	2175
48 x 14	DFRB4814	34.0	30.5	1.42	.66	2195
48 x 16	DFRB4816	34.0	30.5	1.42	.70	2235
48 x 18	DFRB4818	34.0	30.5	1.42	.75	2275
48 x 20	DFRB4820	34.0	30.5	1.42	.80	2340
48 x 24	DFRB4824	34.0	30.5	1.42	.89	3240
48 x 30	DFRB4830	34.0	30.5	1.42	1.03	3600
48 x 36	DFRB4836	34.0	30.5	1.42	1.15	3255
48 x 42	DFRB4842	34.0	30.5	1.42	1.28	4685

Dimensions in inches
Weights in pounds

Available in gray cast iron and ductile iron.
Manufactured in accordance with AWWA/ANSI C110/A21.10.
Flanges are drilled and faced in accordance with ANSI B16.1 CLASS 125

LONG RADIUS BENDS

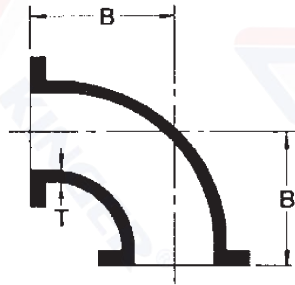

Size	Item No.	B	T	Wt.
2	DFLB290	6.50	.31	20
3	DFLB390	7.75	.48	30
4	DFLB490	9.00	.52	50
5	DFLB590	10.25	.52	65
6	DFLB690	11.50	.55	80
8	DFLB890	14.00	.60	140
10	DFLB1090	16.50	.68	215
12	DFLB1290	19.00	.75	325
14	DFLB1490	21.50	.66	385
16	DFLB1690	24.00	.70	505
18	DFLB1890	26.50	.75	630
20	DFLB2090	29.00	.80	810
24	DFLB2490	34.00	.89	1240
30	DFLB3090	41.50	1.03	2105
36	DFLB3690	49.00	1.15	3285
42	DFLB4290	56.50	1.28	4865
48	DFLB4890	64.00	1.42	6790

BASE BENDS

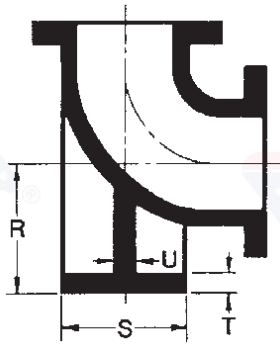

Size	Item No.	R	S	T	U	BC	Weight	
							Base Bend	Base Only
3	DFBB390	4.88	5.00	.56	.50	3.88	35	10
4	DFBB490	5.50	6.00	.62	.50	4.75	55	10
6	DFBB690	7.00	7.00	.69	.62	5.50	85	20
8	DFBB890	8.38	9.00	.94	.88	7.50	145	40
10	DFBB1090	9.75	9.00	.94	.88	7.50	210	45
12	DFBB1290	11.25	11.00	1.00	1.00	9.50	300	65
14	DFBB1490	12.50	11.00	1.00	1.00	9.50	360	70
16	DFBB1690	13.75	11.00	1.00	1.00	9.50	445	75
18	DFBB1890	15.00	13.50	1.12	1.12	11.75	565	115
20	DFBB2090	16.00	13.50	1.12	1.12	11.75	700	120
24	DFBB2490	18.50	13.50	1.12	1.12	11.75	1030	130
30	DFBB3090	23.00	16.00	1.19	1.15	14.25	1625	190
36	DFBB3690	26.00	19.00	1.25	1.15	17.00	2385	250
42	DFBB4290	30.00	23.50	1.44	1.28	21.25	3465	410
48	DFBB4890	34.00	25.00	1.56	1.42	22.75	4610	515

Available in gray cast iron and ductile iron.

Base Bends are manufactured in accordance with AWWA/ANSI C110/A21.10

Bases are faced and drilled unless otherwise specified.

Long Radius Reducing Bends are manufactured in accordance with manufacturer's standards in general guidance of AWWA/ANSI C110/A21.10

Flanges are drilled and faced in accordance with ANSI B16.1 CLASS 125

Dimensions in inches
Weights in pounds

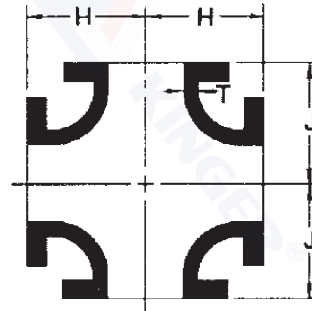
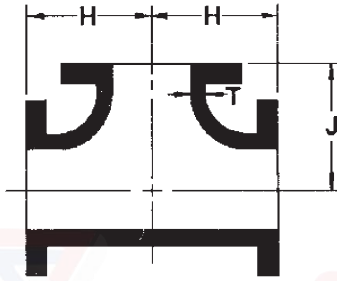

TEES & CROSSES

Size	TEES			CROSSES			
	Item No.	Wt.	H	J	T	Item No.	Wt.
2	DIFT22	20	4.5	4.5	.31	DIFC22	30
3	DIFT33	40	5.5	5.5	.48	DIFC33	50
4	DIFT44	65	6.5	6.5	.52	DIFC44	80
5	DIFT55	85	7.5	7.5	.52	DIFC55	105
6	DIFT66	95	8.0	8.0	.55	DIFC66	120
8	DIFT88	155	9.0	9.0	.60	DIFC88	195
10	DIFT1010	270	11.0	11.0	.80	DIFC1010	330
12	DIFT1212	385	12.0	12.0	.87	DIFC1212	460
14	DIFT1414	435	14.0	14.0	.66	DIFC1414	530
16	DIFT1616	550	15.0	15.0	.70	DIFC1616	665
18	DIFT1818	665	16.5	16.5	.75	DIFC1818	795
20	DIFT2020	855	18.0	18.0	.80	DIFC2020	1015
24	DIFT2424	1330	22.0	22.0	.89	DIFC2424	1570
30	DIFT3030	2160	25.0	25.0	1.03	DIFC3030	2500
36	DIFT3636	3160	28.0	28.0	1.15	DIFC3636	3620
42	DIFT4242	5580	31.0	31.0	1.28	DIFC4242	6155
48	DIFT4848	7385	34.0	34.0	1.42	DIFC4848	8005
54	DIFT5454	8900	37.0	37.0	1.62	N/A	

REDUCING TEES

Size	Item No.	H	J	T	T1	Wt.
6 x 4 x 4	DFRT644	8.0	8.0	.55	.52	85
6 x 4 x 6	DFRT646	8.0	8.0	.55	.52	90
8 x 6 x 4	DFRT864	9.0	9.0	.60	.55	125
8 x 6 x 6	DFRT866	9.0	9.0	.60	.55	135
8 x 6 x 8	DFRT868	9.0	9.0	.60	.65	145

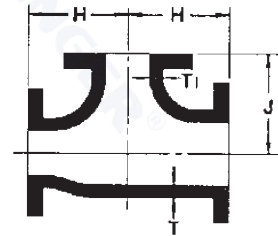

BULLHEAD TEES

Size	Item No.	H	J	T	T1	Wt.
4 x 4 x 6	DFBT446	8.0	8.0	.52	.55	90
6 x 6 x 8	DFBT668	9.0	9.0	.55	.60	140
8 x 8 x 10	DFBT810	11.0	11.0	.60	.67	260
10 x 10 x 12	DFBT1012	12.0	12.0	.80	.87	355

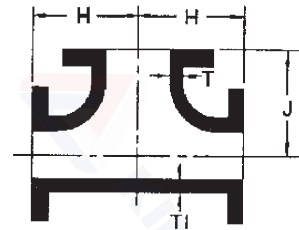

Available in gray cast iron and ductile iron.

Manufactured in accordance with AWWA/ANSI C110/A21.10.

54" fittings are manufactured in accordance with manufacturer's standards in general guidance of AWWA/ANSI C110/A21.10

Flanges are drilled and faced in accordance with ANSI B16.1 CLASS 125

Dimensions in inches
Weights in pounds

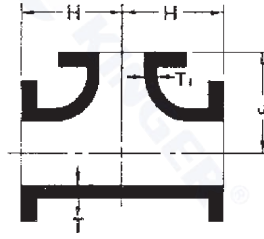

REDUCING TEES

Size	Item No.	H	J	T	T ₁	Wt.	Size	Item No.	H	J	T	T ₁	Wt.
3 x 2	DFRT32	5.5	6.5	.48	.31	35	24 x 6	DFRT246	15.0	19.0	.89	.55	845
4 x 2	DFRT42	6.5	6.5	.52	.31	50	24 x 8	DFRT248	15.0	19.0	.89	.60	860
4 x 2	DFRT425	6.5	6.5	.52	.31	55	24 x 10	DFRT2410	15.0	19.0	.89	.68	880
4 x 3	DFRT43	6.5	6.5	.52	.48	60	24 x 12	DFRT2412	15.0	19.0	.89	.75	890
6 x 2	DFRT62	8.0	8.0	.55	.31	85	24 x 14	DFRT2414	15.0	19.0	.89	.66	900
6 x 3	DFRT63	8.0	8.0	.55	.48	85	24 x 16	DFRT2416	15.0	19.0	.89	.70	915
6 x 4	DFRT64	8.0	8.0	.55	.52	90	24 x 18	DFRT2418	22.0	22.0	.89	.75	1220
8 x 4	DFRT84	9.0	9.0	.60	.52	140	24 x 20	DFRT2420	22.0	22.0	.89	.80	1255
8 x 6	DFRT86	9.0	9.0	.60	.55	145	30 x 12	DFRT3012	18.0	23.0	1.03	.75	1490
10 x 4	DFRT104	11.0	11.0	.68	.52	205	30 x 14	DFRT3014	18.0	23.0	1.03	.66	1490
10 x 6	DFRT106	11.0	11.0	.68	.55	215	30 x 16	DFRT3016	18.0	23.0	1.03	.70	1505
10 x 8	DFRT108	11.0	11.0	.68	.60	225	30 x 18	DFRT3018	18.0	23.0	1.03	.75	1515
12 x 4	DFRT124	12.0	12.0	.75	.52	290	30 x 20	DFRT3020	18.0	23.0	1.03	.80	1540
12 x 6	DFRT126	12.0	12.0	.75	.55	295	30 x 24	DFRT3024	25.0	25.0	1.03	.89	2025
12 x 8	DFRT128	12.0	12.0	.75	.60	310	36 x 12	DFRT3612	20.0	26.0	1.15	.75	2170
12 x 10	DFRT1210	12.0	12.0	.87	.80	360	36 x 14	DFRT3614	20.0	26.0	1.15	.66	2175
14 x 6	DFRT146	14.0	14.0	.66	.55	375	36 x 16	DFRT3616	20.0	26.0	1.15	.70	2185
14 x 8	DFRT148	14.0	14.0	.66	.60	390	36 x 18	DFRT3618	20.0	26.0	1.15	.75	2190
14 x 10	DFRT1410	14.0	14.0	.66	.68	400	36 x 20	DFRT3620	20.0	26.0	1.15	.80	2210
14 x 12	DFRT1412	14.0	14.0	.66	.75	425	36 x 24	DFRT3624	20.0	26.0	1.15	.89	2255
16 x 6	DFRT166	15.0	15.0	.70	.55	465	36 x 30	DFRT3630	28.0	28.0	1.15	1.03	3000
16 x 8	DFRT168	15.0	15.0	.70	.60	475	42 x 12	DFRT4212	23.0	30.0	1.28	.75	3165
16 x 10	DFRT1610	15.0	15.0	.70	.68	495	42 x 14	DFRT4214	23.0	30.0	1.28	.66	3170
16 x 12	DFRT1612	15.0	15.0	.70	.75	520	42 x 16	DFRT4216	23.0	30.0	1.28	.70	3180
16 x 14	DFRT1614	15.0	15.0	.70	.66	530	42 x 18	DFRT4218	23.0	30.0	1.28	.75	3185
18 x 6	DFRT186	13.0	15.5	.75	.55	480	42 x 20	DFRT4220	23.0	30.0	1.28	.80	3205
18 x 8	DFRT188	13.0	15.5	.75	.60	495	42 x 24	DFRT4224	23.0	30.0	1.28	.89	3245
18 x 10	DFRT1810	13.0	15.5	.75	.68	510	42 x 30	DFRT4230	31.0	31.0	1.28	1.03	4125
18 x 12	DFRT1812	13.0	15.5	.75	.75	535	42 x 36	DFRT4236	31.0	31.0	1.28	1.15	5360
18 x 14	DFRT1814	16.5	16.5	.75	.66	630	48 x 12	DFRT4812	26.0	34.0	1.42	.75	4315
18 x 16	DFRT1816	16.5	16.5	.75	.70	650	48 x 14	DFRT4814	26.0	34.0	1.42	.66	4315
20 x 6	DFRT206	14.0	17.0	.80	.55	610	48 x 16	DFRT4816	26.0	34.0	1.42	.70	4330
20 x 8	DFRT208	14.0	17.0	.80	.60	620	48 x 18	DFRT4818	26.0	34.0	1.42	.75	4330
20 x 10	DFRT2010	14.0	17.0	.80	.68	635	48 x 20	DFRT4820	26.0	34.0	1.42	.80	4350
20 x 12	DFRT2012	14.0	17.0	.80	.75	660	48 x 24	DFRT4824	26.0	34.0	1.42	.89	4385
20 x 14	DFRT2014	14.0	17.0	.80	.66	665	48 x 30	DFRT4830	26.0	34.0	1.42	1.03	4455
20 x 16	DFRT2016	18.0	18.0	.80	.70	810	48 x 36	DFRT4836	34.0	34.0	1.42	1.15	5555
20 x 18	DFRT2018	18.0	18.0	.80	.75	820	48 x 42	DFRT4842	34.0	34.0	1.42	1.28	7195

Dimensions in inches
Weights in pounds

Available in gray cast iron and ductile iron.

Manufactured in accordance with AWWA/ANSI C110/A21.10.

Flanges are drilled and faced in accordance with ANSI B16.1 CLASS 125

REDUCING CROSSES

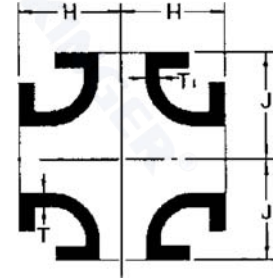

Size	Item No.	H	J	T	T ₁	Wt.
3 x 2	DFRC32	5.5	5.5	.48	.31	45
4 x 2	DFRC42	6.5	6.5	.52	.31	60
4 x 2	DFRC425	6.5	6.5	.52	.31	65
4 x 3	DFRC43	6.5	6.5	.52	.48	70
6 x 2	DFRC62	8.0	8.0	.55	.31	90
6 x 3	DFRC63	8.0	8.0	.55	.48	95
6 x 4	DFRC64	8.0	8.0	.55	.52	110
8 x 4	DFRC84	9.0	9.0	.60	.52	155
8 x 6	DFRC86	9.0	9.0	.60	.55	165
10 x 4	DFRC104	11.0	11.0	.68	.52	220
10 x 6	DFRC106	11.0	11.0	.68	.55	240
10 x 8	DFRC108	11.0	11.0	.68	.60	265
12 x 4	DFRC124	12.0	12.0	.76	.52	310
12 x 6	DFRC126	12.0	12.0	.75	.55	320
12 x 8	DFRC128	12.0	12.0	.75	.60	345
12 x 10	DFRC1210	12.0	12.0	.87	.80	415
14 x 6	DFRC146	14.0	14.0	.66	.55	400
14 x 8	DFRC148	14.0	14.0	.66	.60	425
14 x 10	DFRC1410	14.0	14.0	.66	.68	460
14 x 12	DFRC1412	14.0	14.0	.66	.75	505
16 x 6	DFRC166	15.0	15.0	.70	.55	490
16 x 8	DFRC168	15.0	15.0	.70	.60	520
16 x 10	DFRC1610	15.0	15.0	.70	.68	555
16 x 12	DFRC1612	15.0	15.0	.70	.75	605
16 x 14	DFRC1614	15.0	15.0	.70	.66	620
18x6	DFRC186	13.0	15.5	.75	.55	505
18 x 8	DFRC188	13.0	15.5	.75	.60	535
18 x 10	DFRC1810	13.0	15.5	.75	.68	560
18 x 12	DFRC1812	13.0	15.5	.75	.75	610
18 x 14	DFRC1814	16.5	16.5	.75	.66	720
18 x 16	DFRC1816	16.5	16.5	.75	.70	765
20 x 6	DFRC206	14.0	17.0	.80	.55	635
20 x 8	DFRC208	14.0	17.0	.80	.60	665
20 x 10	DFRC2010	14.0	17.0	.80	.68	685
20 x 12	DFRC2012	14.0	17.0	.80	.75	735
20 x 14	DFRC2014	14.0	17.0	.80	.66	745
20 x 16	DFRC2016	18.0	18.0	.80	.70	915
20 x 18	DFRC2018	18.0	18.0	.80	.75	945
24 x 6	DFRC246	15.0	19.0	.89	.55	875
24 x 8	DFRC248	15.0	19.0	.89	.60	895
24 x 10	DFRC2410	15.0	19.0	.89	.68	930
24 x 12	DFRC2412	15.0	19.0	.89	.75	960
24 x 14	DFRC2414	15.0	19.0	.89	.66	975
24 x 16	DFRC2416	15.0	19.0	.89	.70	1010
24 x 18	DFRC2418	22.0	22.0	.89	.75	1365
24 x 20	DFRC2420	22.0	22.0	.89	.80	1430

Size	Item No.	H	J	T	T ₁	Wt.
30 x 12	DFRC3012	18.0	23.0	1.03	.75	1665
30 x 14	DFRC3014	18.0	23.0	1.03	.66	1570
30 x 16	DFRC3016	18.0	23.0	1.03	.70	1605
30 x 18	DFRC3018	18.0	23.0	1.03	.75	1615
30 x 20	DFRC3020	18.0	23.0	1.03	.80	1670
30 x 24	DFRC3024	25.0	25.0	1.03	.89	2245
36 x 12	DFRC3612	20.0	26.0	1.15	.75	2240
36 x 14	DFRC3614	20.0	26.0	1.15	.66	2240
36 x 16	DFRC3616	20.0	26.0	1.15	.70	2270
36 x 18	DFRC3618	20.0	26.0	1.15	.75	2280
36 x 20	DFRC3620	20.0	26.0	1.15	.80	2325
36 x 24	DFRC3624	20.0	26.0	1.15	.89	2405
36 x 30	DFRC3630	28.0	28.0	1.15	1.03	3300
42 x 12	DFRC4212	23.0	30.0	1.28	.75	3240
42 x 14	DFRC4214	23.0	30.0	1.28	.66	3240
42 x 16	DFRC4216	23.0	30.0	1.28	.70	3270
42 x 18	DFRC4218	23.0	30.0	1.28	.75	3276
42 x 20	DFRC4220	23.0	30.0	1.28	.80	3320
42 x 24	DFRC4224	23.0	30.0	1.28	.89	3395
42 x 30	DFRC4230	31.0	31.0	1.28	1.03	4375
42 x 36	DFRC4236	31.0	31.0	1.28	1.15	5720
48 x 12	DFRC4812	26.0	34.0	1.42	.75	4390
48 x 14	DFRC4814	26.0	34.0	1.42	.66	4385
48 x 16	DFRC4816	26.0	34.0	1.42	.70	4415
48 x 18	DFRC4818	26.0	34.0	1.42	.75	4420
48 x 20	DFRC4820	26.0	34.0	1.42	.80	4460
48 x 24	DFRC4824	26.0	34.0	1.42	.89	4535
48 x 30	DFRC4830	26.0	34.0	1.42	1.03	4670
48 x 36	DFRC4836	34.0	34.0	1.42	1.15	5880
48 x 42	DFRC4842	34.0	34.0	1.42	1.28	7630

Dimensions in inches
Weights in pounds

Available in gray cast iron and ductile iron.

Manufactured in accordance with AWWA/ANSI C110/A21.10.

Flanges are drilled and faced in accordance with ANSI B16.1 CLASS 125

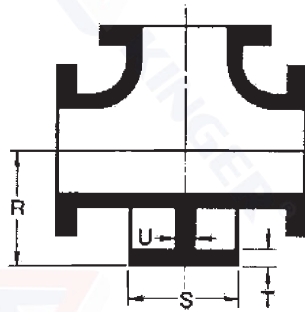

BASE TEES

Size	Item No.	R	S	T	U	BC	Bolt Hole Diam.	Weight	
								Base Tee	Base Only
3	DFBT33	4.88	5.00	.56	.50	3.88	5/8	45	5
4	DFBT44	5.60	6.00	.62	.50	4.75	3/4	75	10
6	DFBT66	7.00	7.00	.69	.62	5.50	3/4	110	15
8	DFBT88	8.38	9.00	.94	.88	7.50	3/4	185	30
10	DFBT1010	9.75	9.00	.94	.88	7.50	3/4	300	30
12	DFBT1212	11.25	11.00	1.00	1.00	9.50	7/8	430	45
14	DFBT1414	12.50	11.00	1.00	1.00	9.50	7/8	485	60
16	DFBT1616	13.75	11.00	1.00	1.00	9.50	7/8	600	50
18	DFBT1818	15.00	13.50	1.12	1.12	11.75	7/8	740	75
20	DFBT2020	16.00	13.50	1.12	1.12	11.75	7/8	930	75
24	DFBT2424	18.50	13.50	1.12	1.12	11.75	7/8	1410	80
30	DFBT3030	23.00	16.00	1.19	1.15	14.25	1	2270	120
36	DFBT3636	26.00	19.00	1.25	1.15	17.00	1	3320	160
42	DFBT4242	30.00	23.50	1.44	1.28	21.25	1 1/8	5850	270
48	DFBT4848	34.00	26.00	1.56	1.42	22.75	1 1/4	7720	335

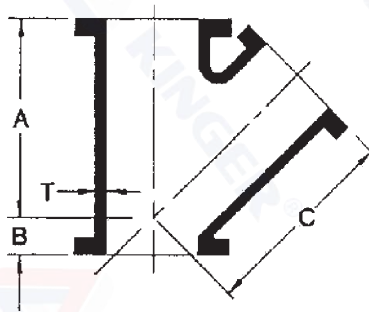

45 DEG LATERAL WYES

Size	Item No.	A	B	C	T	Wt.
3	DFLY33	10.0	3.0	10.0	.48	45
4	DFLY44	12.0	3.0	12.0	.52	75
6	DFLY66	14.5	3.5	14.5	.55	120
8	DFLY88	17.5	4.5	17.5	.60	200
10	DFLY1010	20.5	5.0	20.5	.80	335
12	DFLY1212	24.5	5.5	24.5	.87	515
14	DFLY1414	27.0	6.0	27.0	.66	605
16	DFLY1616	30.0	6.5	30.0	.70	805
18	DFLY1818	32.0	7.0	32.0	.75	980
20	DFLY2020	35.0	8.0	35.0	.80	1265
24	DFLY2424	40.5	9.0	40.5	.89	1905
30	DFLY3030	49.0	10.0	49.0	1.03	3225
36	DFLY3636	60.0	19.5	60.0	1.15	5740
42	DFLY4242	68.5	21.0	68.5	1.28	9170
48	DFLY4848	77.0	22.5	77.0	1.42	12100

Dimensions in inches
Weights in pounds

Available in gray cast iron and ductile iron.

Manufactured in accordance with AWWA/ANSI C110/A21.10.

Flanges are drilled and faced in accordance with ANSI B16.1 CLASS 125

45 DEG REDUCING LATERAL WYES

Size.	Item No.	A	B	C	T	T1	Wt.
4 x 3	DFRY43	12.0	3.0	12.0	.52	.48	65
6 x 3	DFRY63	14.5	3.5	14.5	.55	.48	100
6 x 4	DFRY64	14.5	3.5	14.5	.55	.52	115
8 x 4	DFRY84	17.5	4.5	17.5	.60	.52	180
8 x 6	DFRY86	17.5	4.5	17.5	.60	.55	189
10 x 4	DFRY104	20.6	5.0	20.5	.68	.62	260
10 x 6	DFRY106	20.5	6.0	20.5	.68	.55	270
10 x 8	DFRY108	20.6	5.0	20.5	.68	.60	295
12 x 4	DFRY124	24.6	5.5	24.5	.75	.52	380
12 x 6	DFRY126	24.5	5.5	24.5	.75	.55	395
12 x 8	DFRY128	24.5	5.5	24.5	.75	.60	420
12 x 10	DFRY1210	24.5	5.5	24.5	.87	.80	455
14 x 6	DFRY146	27.0	6.0	27.0	.66	.55	520
14 x 8	DFRY148	27.0	6.0	27.0	.66	.60	545
14 x 10	DFRY1410	27.0	6.0	27.0	.66	.68	525
14 x 12	DFRY1412	27.0	6.0	27.0	.66	.75	620
16 x 6	DFRY166	30.0	6.5	30.0	.70	.56	620
16 x 8	DFRY168	30.0	6.5	30.0	.70	.60	710
16 x 10	DFRY1610	30.0	6.5	30.0	.70	.68	740
16 x 12	DFRY1612	30.0	6.5	30.0	.70	.75	715
16 x 14	DFRY1614	30.0	6.5	30.0	.70	.66	830
18 x 6	DFRY186	32.0	7.0	32.0	.75	.56	450
18 x 8	DFRY188	32.0	7.0	32.0	.75	.60	625
18 x 10	DFRY1810	32.0	7.0	32.0	.75	.68	885
18 x 12	DFRY1812	32.0	7.0	32.0	.75	.75	930
18 x 14	DFRY1814	32.0	7.0	32.0	.75	.66	975
18 x 16	DFRY1816	32.0	7.0	32.0	.75	.70	1025
20 x 8	DFRY208	35.0	8.0	35.0	.80	.60	740
20 x 10	DFRY2010	35.0	8.0	35.0	.80	.68	805
20 x 12	DFRY2012	35.0	8.0	35.0	.80	.75	1110
20 x 14	DFRY2014	35.0	8.0	35.0	.80	.66	1215
20 x 16	DFRY2016	35.0	8.0	35.0	.80	.70	1270
20 x 18	DFRY2018	35.0	8.0	35.0	.80	.75	1200

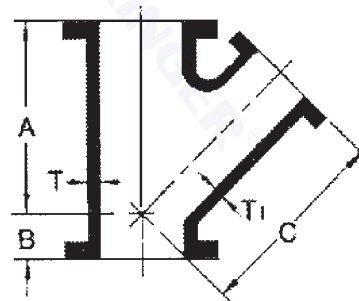

Size	Item No.	A	B	C	T	T1	Wt.
24 x 8	DFRY248	40.5	9.0	40.5	.89	.60	1080
24 x 10	DFRY2410	40.5	9.0	40.5	.89	.68	1105
24 x 12	DFRY2412	40.5	9.0	40.5	.89	.75	1200
24 x 14	DFRY2414	40.5	9.0	40.5	.89	.66	1750
24 x 16	DFRY2416	40.5	9.0	40.5	.89	.70	1640
24 x 18	DFRY2418	40.5	9.0	40.5	.89	.75	1855
24 x 20	DFRY2420	40.5	9.0	40.5	.89	.80	1750
30 x 12	DFRY3012	49.0	10.0	49.0	1.03	.75	2795
30 x 14	DFRY3014	49.0	10.0	49.0	1.03	.66	2850
30 x 16	DFRY3016	49.0	10.0	49.0	1.03	.70	2905
30 x 18	DFRY3018	49.0	10.0	49.0	1.03	.75	2960
30 x 20	DFRY3020	49.0	10.0	49.0	1.03	.80	3040
30 x 24	DFRY3024	49.0	10.0	49.0	1.03	.89	3205
36 x 12	DFRY3612	60.0	19.5	60.0	1.15	.75	4490
36 x 14	DFRY3614	60.0	19.5	60.0	1.15	.66	4545
36 x 16	DFRY3616	60.0	19.5	60.0	1.15	.70	4455
36 x 18	DFRY3618	60.0	19.5	60.0	1.15	.75	4670
36 x 20	DFRY3620	60.0	19.5	60.0	1.15	.80	4575
36 x 24	DFRY3624	60.0	19.5	60.0	1.15	.89	4725
36 x 30	DFRY3630	60.0	19.5	60.0	1.15	1.03	5200
42 x 12	DFRY4212	68.5	21.0	68.5	1.28	.75	5725
42 x 14	DFRY4214	68.5	21.0	68.5	1.28	.66	5800
42 x 16	DFRY4216	68.5	21.0	68.5	1.28	.70	5850
42 x 18	DFRY4218	68.5	21.0	68.5	1.28	.75	6000
42 x 20	DFRY4220	68.5	21.0	68.5	1.28	.80	6110
42 x 24	DFRY4224	68.5	21.0	68.5	1.28	.89	6255
42 x 30	DFRY4230	68.5	21.0	68.5	1.28	1.03	6855
42 x 36	DFRY4236	68.5	21.0	68.5	1.28	1.15	7650
48 x 12	DFRY4812	77.0	22.5	77.0	1.42	.75	7200
48 x 14	DFRY4814	77.0	22.5	77.0	1.42	.66	7275
48 x 16	DFRY4816	77.0	22.6	77.0	1.42	.70	7400
48 x 18	DFRY4818	77.0	22.5	77.0	1.42	.75	7620
48 x 20	DFRY4820	77.0	22.5	77.0	1.42	.80	7685
48 x 24	DFRY4824	77.0	22.5	77.0	1.42	.89	6840
48 x 30	DFRY4830	77.0	22.5	77.0	1.42	1.03	8015
48 x 36	DFRY4836	77.0	22.5	77.0	1.42	1.15	8970
48 x 42	DFRY4842	77.0	22.5	77.0	1.42	1.28	11010

Available in gray cast iron and ductile iron.

Base Tees are in accordance with AWWA/ANSI C110/A21.10.

Bases are faced and drilled unless otherwise specified.

45 Deg Lateral Wyes are manufactured in accordance with manufacturer's standards in general guidance of AWWA/ANSI C110/A21.10

Flanges are drilled and faced in accordance with ANSI B16.1 CLASS 125

Dimensions in inches
Weights in pounds

CONCENTRIC REDUCERS

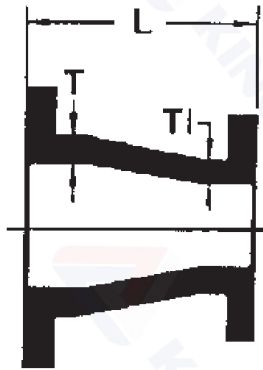

Size	Item No.	L	T	T1	Wt.
3 x 2	DFCR32	6	.48	.31	16
3 x 2 1/2	DFCR325	6	.48	.31	21
4 x 2	DFCR42	7	.52	.31	25
4 x 2 1/2	DFCR425	7	.52	.31	28
4 x 3	DFCR43	7	.52	.48	30
6 x 2	DFCR62	9	.55	.31	35
6 x 2 1/2	DFCR625	9	.55	.31	38
6 x 3	DFCR63	9	.55	.48	40
6 x 4	DFCR64	9	.55	.52	45
6 x 5	DFCR65	9	.55	.52	51
8 x 4	DFCR84	11	.60	.52	65
8 x 5	DFCR85	11	.60	.52	70
8 x 6	DFCR86	11	.60	.55	75
10 x 4	DFCR104	12	.68	.52	85
10 x 6	DFCR106	12	.68	.55	90
10 x 8	DFCR108	12	.68	.60	110
12 x 4	DFCR124	14	.75	.52	120
12 x 6	DFCR126	14	.75	.55	130
12 x 8	DFCR128	14	.75	.60	145
12 x 10	DFCR1210	14	.75	.68	170
14 x 6	DFCR146	16	.66	.55	155
14 x 8	DFCR148	16	.66	.60	175
14 x 10	DFCR1410	16	.66	.68	190
14 x 12	DFCR1412	16	.66	.75	220
16x6	DFCR166	18	.70	.55	190
16 x 8	DFCR168	18	.70	.60	210
16 x 10	DFCR1610	18	.70	.68	235
16 x 12	DFCR1612	18	.70	.75	265
16 x 14	DFCR1614	18	.70	.66	280
18 x 8	DFCR188	19	.75	.60	240
18 x 10	DFCR1810	19	.75	.68	265
18 x 12	DFCR1812	19	.75	.75	295
18 x 14	DFCR1814	19	.75	.66	305
18 x 16	DFCR1816	19	.75	.70	340
20 x 10	DFCR2010	20	.80	.68	310
20 x 12	DFCR2012	20	.80	.75	345
20 x 14	DFCR2014	20	.80	.66	355
20 x 16	DFCR2016	20	.80	.70	390
20 x 18	DFCR2018	20	.80	.75	410
24 x 12	DFCR2412	24	.89	.75	480
24 x 14	DFCR2414	24	.89	.66	490
24 x 16	DFCR2416	24	.89	.70	525
24 x 18	DFCR2418	24	.89	.75	550
24 x 20	DFCR2420	24	.89	.80	590
30 x 18	DFCR3018	30	1.03	.75	810
30 x 20	DFCR3020	30	1.03	.80	870
30 x 24	DFCR3024	30	1.03	.89	970
36 x 20	DFCR3620	36	1.15	.80	1230
36 x 24	DFCR3624	36	1.15	.89	1345
36 x 30	DFCR3630	36	1.15	1.03	1555
42 x 24	DFCR4224	42	1.28	.89	1820
42 x 30	DFCR4230	42	1.28	1.03	2060
42 x 36	DFCR4236	42	1.28	1.15	2345
48 x 30	DFCR4830	48	1.42	1.03	2625
48 x 36	DFCR4836	48	1.42	1.15	2950
48 x 42	DFCR4842	48	1.42	1.28	3320
54 x 48	DFCR5448	64	1.62	1.42	5330

Dimensions in inches
Weights in pounds

Available in gray cast iron and ductile iron.

45 Deg Lateral Wyes are manufactured in accordance with manufacturer's standards in general guidance of AWWA/ANSI C110/A21.10

Flanges are drilled and faced in accordance with ANSI B16.1 CLASS 125

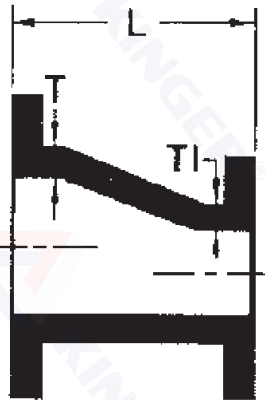

ECCENTRIC REDUCERS

Size	Item No.	L	T	T1	Wt.
3 x 2	DFER32	6	.48	.31	16
3 x 2 1/2	DFER325	6	.48	.31	21
4 x 2	DFER42	7	.52	.31	25
4 x 2 1/2	DFER425	7	.52	.31	28
4 x 3	DFER43	7	.52	.48	30
6 x 2	DFER62	9	.55	.31	35
6 x 2 1/2	DFER625	9	.55	.31	38
6 x 3	DFER63	9	.55	.48	40
6 x 4	DFER64	9	.55	.52	45
6 x 5	DFER65	9	.55	.52	51
8 x 4	DFER84	11	.60	.52	65
8 x 5	DFER85	11	.60	.52	70
8 x 6	DFER86	11	.60	.55	75
10 x 4	DFER104	12	.68	.52	85
10 x 6	DFER106	12	.68	.55	90
10 x 8	DFER108	12	.68	.60	110
12 x 4	DFER124	14	.75	.62	120
12 x 6	DFER126	14	.75	.55	130
12 x 8	DFER128	14	.75	.60	145
12 x 10	DFER1210	14	.75	.68	170
14 x 6	DFER146	16	.66	.55	155
14 x 8	DFER148	16	.66	.60	175
14 x 10	DFER1410	16	.66	.68	190
14 x 12	DFER1412	16	.66	.75	220
16 x 6	DFER166	18	.70	.55	190
16 x 8	DFER168	18	.70	.60	210
16 x 10	DFER1610	18	.70	.68	235
16 x 12	DFER1612	18	.70	.75	265
16 x 14	DFER1614	18	.70	.66	280

Size	Item No.	L	T	T1	Wt.
18 x 8	DFER188	19	.75	.60	240
18 x 10	DFER1810	19	.75	.68	265
18 x 12	DFER1812	19	.75	.75	295
18 x 14	DFER1814	19	.75	.66	310
18 x 16	DFER1816	19	.75	.70	340
20 x 10	DFER2010	20	.80	.68	310
20 x 12	DFER2012	20	.80	.75	345
20 x 14	DFER2014	20	.80	.66	355
20 x 16	DFER2016	20	.80	.70	390
20 x 18	DFER2018	20	.80	.75	410
24 x 12	DFER2412	24	.89	.75	480
24 x 14	DFER2414	24	.89	.66	490
24 x 16	DFER2416	24	.89	.70	525
24 x 18	DFER2418	24	.89	.75	550
24 x 20	DFER2420	24	.89	.80	590
30 x 18	DFER3018	30	1.03	.75	810
30 x 20	DFER3020	30	1.03	.80	870
30 x 24	DFER3024	30	1.03	.89	970
36 x 20	DFER3620	36	1.15	.80	1230
36 x 24	DFER3624	36	1.15	.89	1345
36 x 30	DFER3630	36	1.15	1.03	1555
42 x 24	DFER4224	42	1.28	.89	1820
42 x 30	DFER4230	42	1.28	1.03	2060
42 x 36	DFER4236	42	1.28	1.15	2345
48 x 30	DFER4830	48	1.42	1.03	2625
48 x 36	DFER4836	48	1.42	1.15	2950
48 x 42	DFER4842	48	1.42	1.28	3320

Dimensions in inches
Weights in pounds

Available in gray cast iron and ductile iron.

Manufactured in accordance with AWWA/ANSI C110/A21.10.

54" fittings are in accordance with manufacturer's standards in general guidance of AWWA/ANSI C110/A21.10

Flanges are drilled and faced in accordance with ANSI B16.1 CLASS 125

BLIND FLANGES

Size	Item No.		O	Q	V	Wt.
	Solid	Tapped				
3	DSBF3	DTBF3	7.50	.75	.69	9
4	DSBF4	DTBF4	9.00	.94	.88	14
6	DSBF6	DTBF6	11.00	1.00	.94	24
8	DSBF8	DTBF8	13.50	1.12	1.06	38
10	DSBF10	DTBF10	16.00	1.19	1.12	59
12	DSBF12	DTBF12	19.00	1.25	.81	76
14	DSBF14	DTBF14	21.00	1.38	.88	110
16	DSBF16	DTBF16	23.50	1.44	1.00	145
18	DSBF18	DTBF18	25.00	1.56	1.06	185
20	DSBF20	DTBF20	27.50	1.69	1.12	217
24	DSBF24	DTBF24	32.00	1.88	1.25	370
30	DSBF30	DTBF30	38.75	2.12	1.44	500
36	DSBF36	DTBF36	46.00	2.38	1.62	790
42	DSBF42	DTBF42	53.00	2.62	1.81	1175
48	DSBF48	DTBF48	59.50	2.75	2.00	1585
54	DSBF54	DTBF54	66.25	3.00	2.25	2600

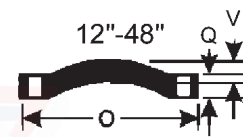
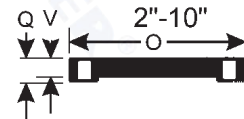

Available in gray cast iron and ductile iron.

Manufactured in accordance with AWWA/ANSI C110/A21.10.

Flanges are drilled and faced in accordance with ANSI B16.1 CLASS 125

Tap will be 2" dia. unless requested otherwise.

TRUE WYES

Size	Item No.	A	B	T	Wt.
3x3	DFTW33	5.5	3.0	.48	30
4x4	DFTW44	6.5	3.0	.52	55
6x4	DFTW64	8.0	3.5	.55	60
6x6	DFTW66	8.0	3.5	.55	85
8x6	DFTW86	9.0	4.5	.60	100
8x8	DFTW88	9.0	4.5	.60	140
10 x 8	DFTW108	11.0	6.0	.68	155
10 x 10	DFTW1010	11.0	5.0	.68	185
12 x 8	DFTW128	12.0	5.5	.75	210
12 x 12	DFTW1212	12.0	5.5	.75	300
14 x 14	DFTW1414	14.0	6.0	.66	415
16 x 16	DFTW1616	15.0	6.5	.70	580
18 x 18	DFTW1818	16.5	7.0	.75	680
20 x 20	DFTW2020	18.0	8.0	.80	960
24 x 24	DFTW2424	22.0	9.0	.89	1370
30 x 30	DFTW3030	25.0	10.0	1.03	2630
36 x 36	DFTW3636	28.0	19.5	1.15	3860
42 x 42	DFTW4242	31.0	21.0	1.28	5280
48 x 48	DFTW4848	34.01	22.5	1.42	6850

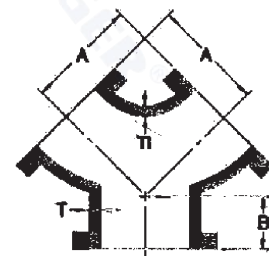

Available in gray cast iron and ductile iron.

Manufactured in accordance with manufacturer's standards

Flanges are drilled and faced in accordance with ANSI B16.1 CLASS 125

Dimensions in inches

Weights in pounds

Available in gray cast iron and ductile iron.

Manufactured in accordance with AWWA/ANSI C110/A21.10

Flanges are drilled and faced in accordance with ANSI B16.1 CLASS 125

STRAIGHT FLARE PIECES

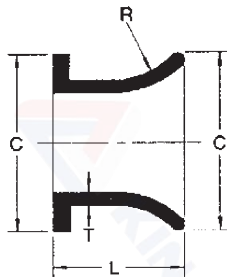

Size:	Item No.	T	C	L	R	Wt
3	DFSF3	.40	7.50	8	6	20
4	DFSF4	.40	9.00	8	6	30
6	DFSF6	.45	11.00	8	6	40
8	DFSF8	.53	13.50	10	8	70
10	DFSF10	.55	16.00	10	10	95
12	DFSF12	.60	19.00	12	12	155
14	DFSF14	.65	21.00	12	14	165
16	DFSF16	.70	23.50	16	16	240
18	DFSF18	.75	25.00	16	18	275
20	DFSF20	.80	27.50	18	20	355
24	DFSF24	.90	32.00	18	24	480
30	DFSF30	1.07	38.75	24	30	1100
36	DFSF36	1.19	46.00	24	36	1460
42	DFSF42	1.32	53.00	30	42	1750
48	DFSF48	1.44	59.50	30	48	2375

90 DEG FLARE BENDS

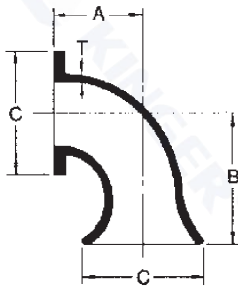

Size:	Item No.	T	C	A	B	Wt
3	DFFB390	.40	7.50	5.5	11	30
4	DFFB490	.40	9.00	6.5	12	45
6	DFFB690	.45	11.00	8.0	12	75
8	DFFB890	.53	13.50	9.0	14	120
10	DFFB1090	.55	16.00	11.0	17	195
12	DFFB1290	.60	19.00	12.0	18	275
14	DFFB1490	.65	21.00	14.0	20	340
16	DFFB1690	.70	23.50	15.0	21	460
18	DFFB1890	.75	25.00	16.5	22.5	560
20	DFFB2090	.80	27.50	18.0	24	700
24	DFFB2490	.90	32.00	22.0	28	1100
30	DFFB3090	1.07	38.75	25.0	32	1970
36	DFFB3690	1.19	46.00	28.0	35	2730
42	DFFB4290	1.32	63.00	31.0	38	3200
48	DFFB4890	1.44	59.50	34.0	41	5235

LONG RADIUS 90 DEG FLARE BENDS

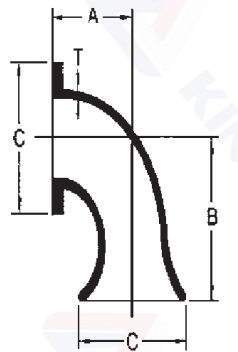

Size:	Item No.	T	C	A	B	Wt
4	DFLB490	.40	9.00	9.00	14.50	50
6	DFLB690	.45	11.00	11.50	15.50	90
8	DFLB890	.53	13.50	14.00	19.00	155
10	DFLB1090	.55	16.00	16.50	22.50	250
12	DFLB1290	.60	19.00	19.00	25.00	375
14	DFLB1490	.65	21.00	21.50	27.50	500
16	DFLB1690	.70	23.50	24.00	30.00	715
18	DFLB1890	.75	25.00	26.50	32.50	800
20	DFLB2090	.80	27.50	29.00	35.00	1140
24	DFLB2490	.90	32.00	34.00	40.00	1335
30	DFLB3090	1.07	38.75	41.50	48.50	2190
36	DFLB3690	1.19	46.00	49.00	56.00	3465
42	DFLB4290	1.32	53.00	56.50	63.50	5150
48	DFLB4890	1.44	59.50	64.00	71.00	6725

Dimensions in inches
Weights in pounds

Available in gray cast iron and ductile iron.

Manufactured in accordance with manufacturer's standards

Flanges are drilled and faced in accordance with ANSI B16.1 CLASS 125

BOSS AND TAP LOCATIONS

METHOD OF DESIGNATING LOCATION OF TAPPED HOLES
AND/OR BOSSES IN CAST IRON FLANGED FITTINGS

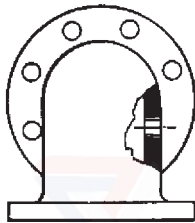

TAPPED HOLE THROUGH WALL

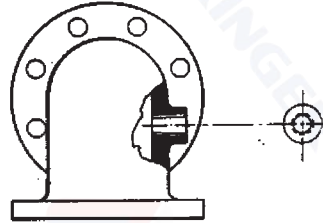

REGULAR BOSS WITH PIPE TAP

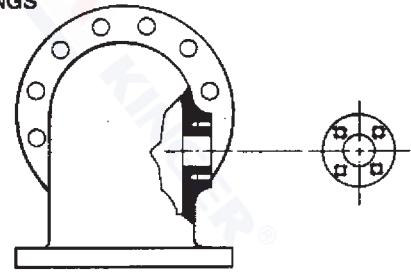

FLANGE BOSS WITH BLIND TAPPED HOLES

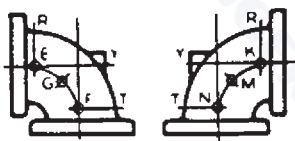

90° ELBOW
STRAIGHT SIZE

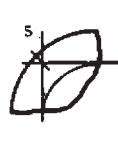

90° ELBOW

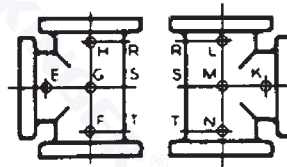

TEE
STRAIGHT SIZE

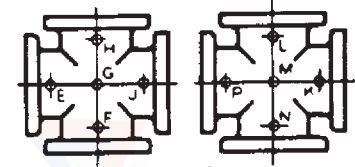

CROSS
STRAIGHT SIZE

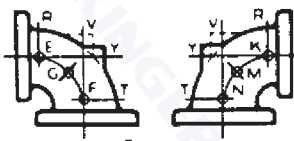

90° ELBOW
REDUCING SIZE

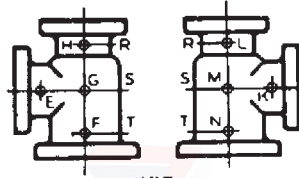

TEE
REDUCING SIZE

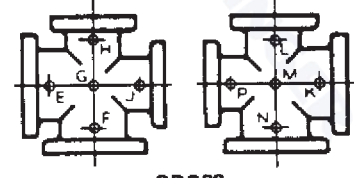

CROSS
REDUCING SIZE

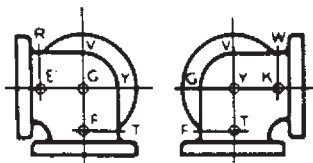

FRONT VIEW SIDE VIEW
SIDE OUTLET 90° ELBOW
STRAIGHT SIZE

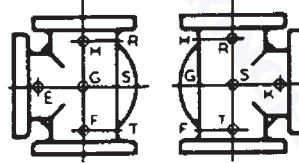

FRONT VIEW SIDE VIEW
SIDE OUTLET TEE
STRAIGHT SIZE

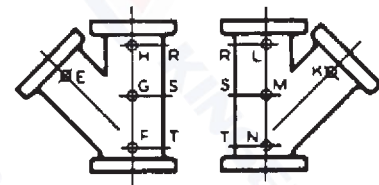

45° LATERAL
STRAIGHT SIZE

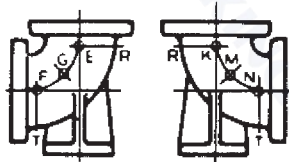

90° BASE ELBOW

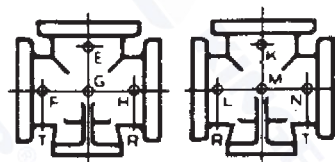

BASE TEE

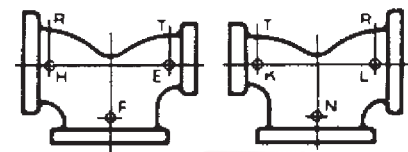

DOUBLE BRANCH ELBOW



TRUE 'Y'

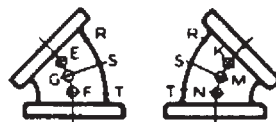

45° ELBOW

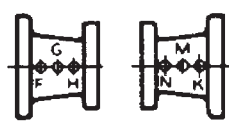

REDUCER



ECCENTRIC REDUCER

The illustrations show two views of the same fitting and represent fittings with symmetrical shapes, with the exception of the side outlet elbow and the side outlet tee.

When a cast iron flanged fitting is wanted with a tapped connection, give the size of the tapping required, and designate its location by means of a letter selected from the correct view of the fitting in question

DESIGNATION OF OUTLETS

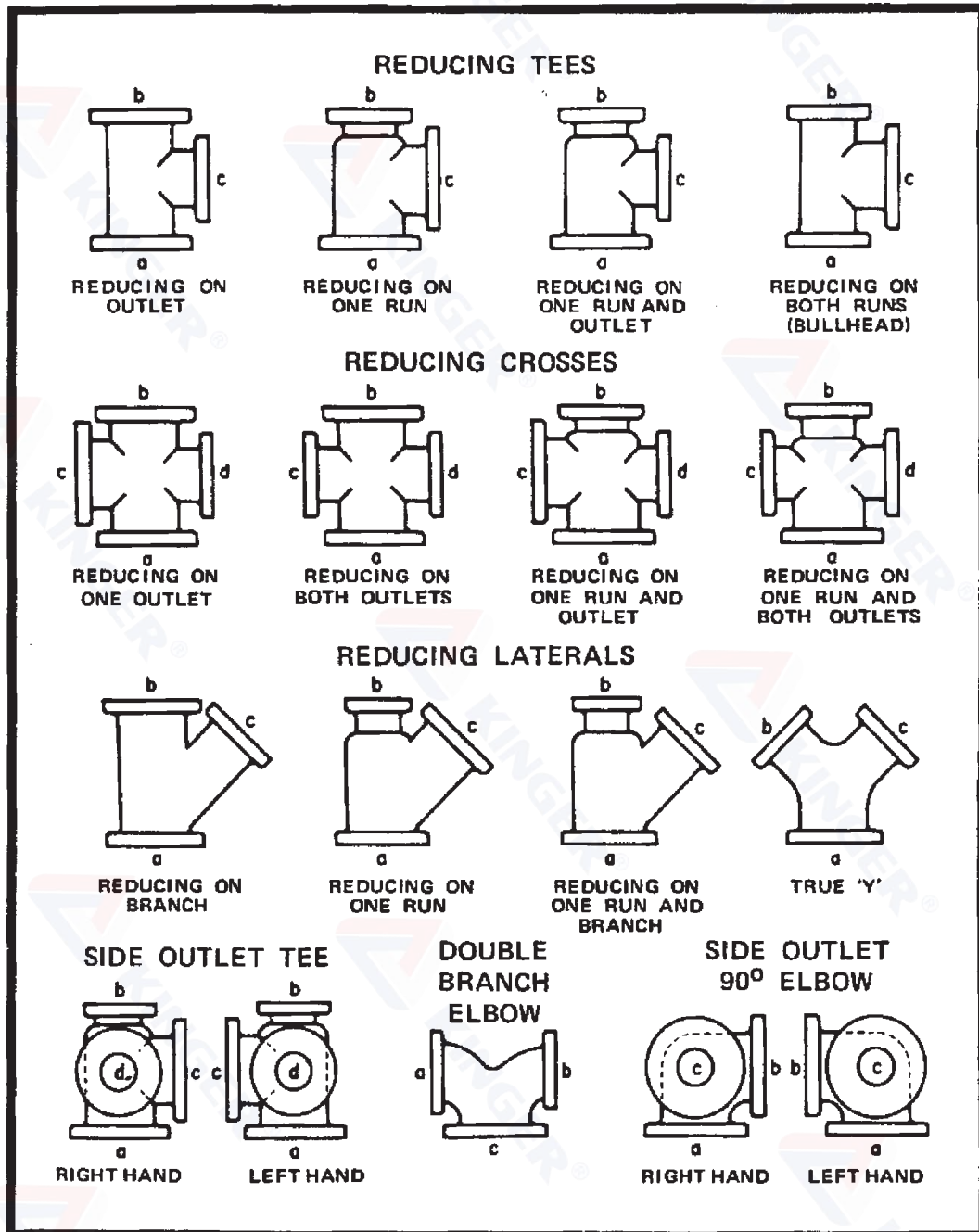

The largest opening establishes the basic size of a reducing fitting. The largest opening is named first, except for bull head tees, which are reducing on both runs and for double branch elbows where both branches are reducing. The outlet is the largest opening and named last in both cases.

In designating the openings of reducing fittings, they should be read in the order indicated by the sequence of the letters; a, b, c, and d. In designating the outlets of side outlet reducing fittings, the side outlet is named last. In the case of the cross, which is not shown, the side outlet is designated by the letter e.